

- EST. 1840 -



CLIFTON ARMS



HOTEL

YOUR CONFERENCE
YOUR
CLIFTON ARMS

CLIFTONARMSLYTHAM.COM

EST. 1840



CLIFTON ARMS



HOTEL

Conferences, business meetings and special events at the Clifton Arms Hotel all have the advantages of modern technology, combined with the excellence of the food and service offered to all our guests.

Whether visiting the Clifton Arms Hotel for the first time as a conference delegate or attending a presentation, you will always be greeted with a warm welcome.

Whatever your requirements, formal or informal, conference, seminar, meeting, training event, interviews – we have a choice of versatile conference suites and we take pleasure in providing you with our four star service from your initial enquiry to the close of the event.

Kind regards

Victoria Dolman
GENERAL MANAGER

West Beach, Lytham, Lancashire, FY8 5QJ

T: 01253 739898
functions@cliftonarms-lytham.com

CLIFTONARMSLYTHAM.COM



A perfect setting

DAY DELEGATE PACKAGE



This rate includes conference room hire, bottled water, stationery, screen, projector, three servings of tea/coffee with croissants on arrival, mid-morning homemade shortbread biscuits and cakes in the afternoon. A delicious two course buffet lunch will be served in our restaurant.

£35.00 per person

24 HOUR DELEGATE PACKAGE



This rate includes the Day Delegate Package along with overnight accommodation, table d'hôte dinner in either the restaurant or a private dining room and our fantastic full Lancashire breakfast.

Please note that special corporate rates can be negotiated and we can tailor packages to suit your individual requirements – Contact Us!

£150.00 per person

A perfect setting

THE BALLROOM



Grand events deserve a grand setting. From corporate launches to *conferences* and *industry awards*. Our Ballroom offers the perfect venue for it all – offering the space and *flexibility* to meet your needs, whatever the occasion.

SUGGESTED ROOM PLAN

Cabaret Style

ROOM TOTAL: UP TO 64 SEATED

ROOM SIZE: 15.6M X 17.2M



A perfect setting

THE BALLROOM



SUGGESTED ROOM PLANS

Theatre Style

ROOM TOTAL: UP TO 100 SEATED

ROOM SIZE: 15.5M X 17.0M

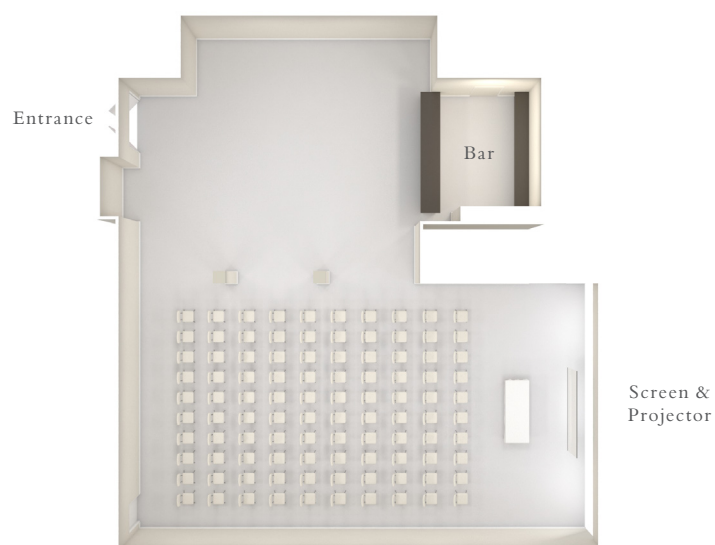

Horseshoe Style

ROOM TOTAL: UP TO 64 SEATED

ROOM SIZE: 15.5M X 17.0M



THE CLIFTON SUITE



The views across Lytham Green from the Clifton Suite are *stunning*, and the setting within is just as *impressive*. Tastefully decorated and well equipped, this is a *versatile space* that's just as fitting for *meetings*, drinks receptions and networking events.

SUGGESTED ROOM PLANS

Boardroom Style

ROOM TOTAL: UP TO 22 SEATED

ROOM SIZE: 12M X 5.5M

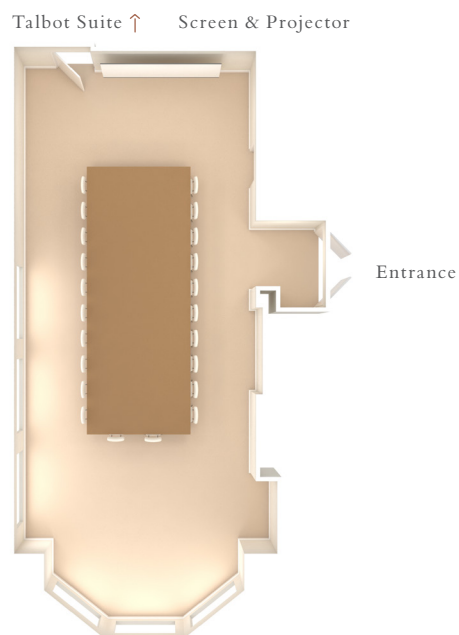

A perfect setting

THE CLIFTON SUITE



SUGGESTED ROOM PLANS

Theatre Style

ROOM TOTAL: UP TO 48 SEATED

ROOM SIZE: 12M X 5.5M

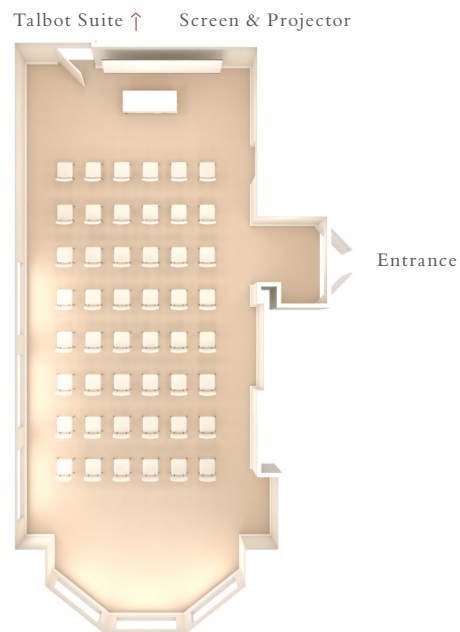

Horseshoe Cabaret Style

ROOM TOTAL: UP TO 48 SEATED

ROOM SIZE: 12M X 5.5M

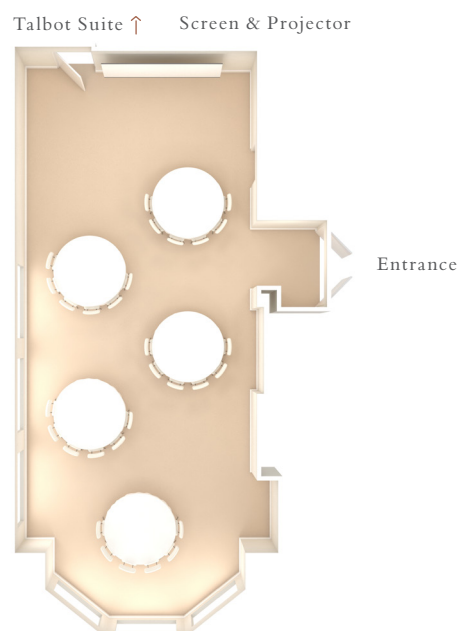

THE LIBRARY



Our Library is a room for *smaller meetings*, where you can enjoy *refined* surroundings and fantastic *views* across the estuary.

SUGGESTED ROOM PLAN

Boardroom Style

ROOM TOTAL: UP TO 12 SEATED

ROOM SIZE: 6.5M X 4.5M

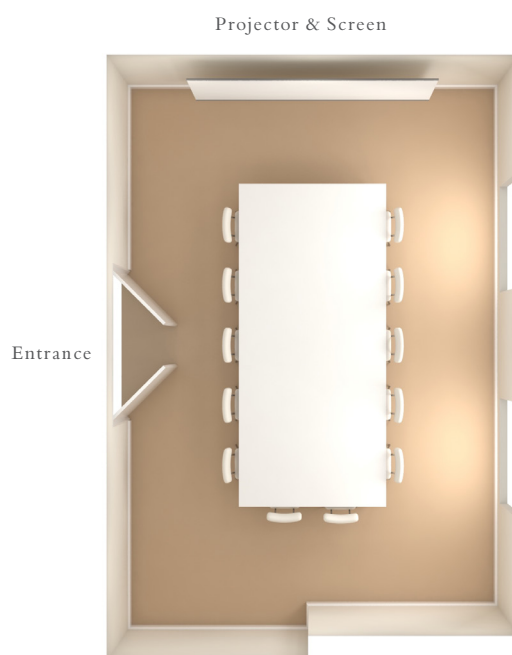

A perfect setting

THE TALBOT SUITE



Our Talbot Suite is a space made for the *hubbub* of networking *events* and smaller conferences. With its own private bar, it's ready to *welcome* your guests.

SUGGESTED ROOM PLAN

Informal Style

ROOM TOTAL: UP TO 30 SEATED

ROOM SIZE: 9.5M X 13M

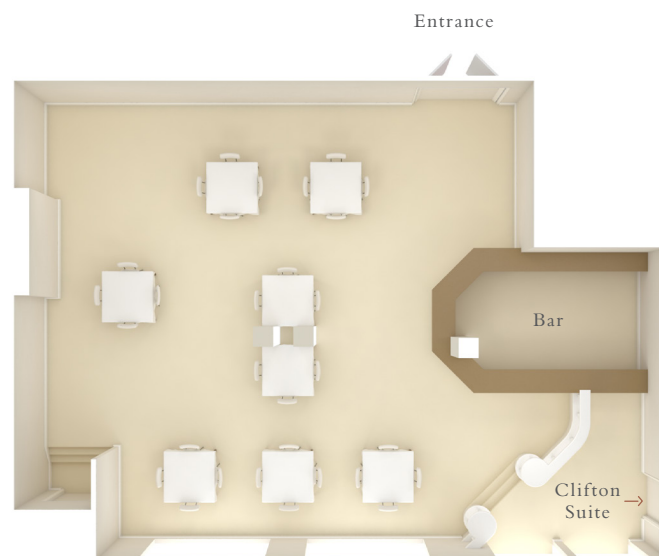

A perfect setting